

HF-35(D950) 1 Speed Drilling System Exploded View & Parts list (N)

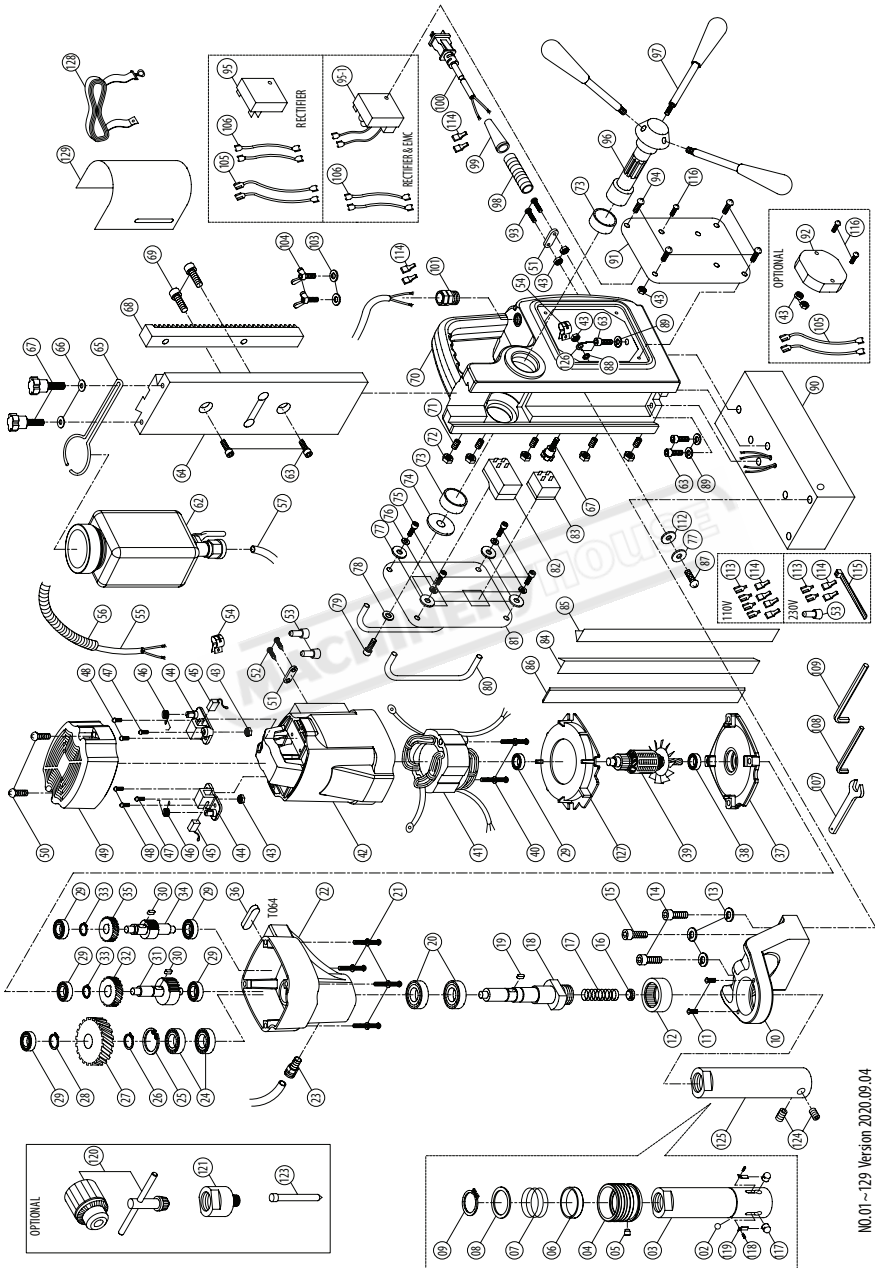

NO.01-129 Version 2020.09.04

NO.	Parts Name	QTY	69	SOCKET CAP SCREW (M8x16xP1.25)	2
1	N/A	-	70	STAND BODY	1
2	CHECK BALL (Ø8)	1	71	SOCKET SET SCREW (M5x20xP0.8)	5
3	QUICK RELEASE ARBOR SHAFT (M27-122.5L)	1	72	HEX NUT (M5xP0.8)	5
4	QUICK-RELEASE COLLAR	1	73	BUSHING (Ø28xØ32x12)	2
5	COLLAR PIN (Ø8)	1	74	FLAT WASHER (Ø6xØ40x2.5)	1
6	RING (Ø40xØ44x9)	1	75	SOCKET CAP SCREW (M4x16xP0.7)	4
7	SPRING (Ø2.3xØ39xØ43.6x3T1x30L)	1	76	SPRING WASHER (M4)	4
8	SPRING SEAT RING (Ø35.1xØ44.5x2)	1	77	FLAT WASHER (Ø4xØ10x1)	5
9	EXTERNAL CIRCLIP (S-35)	1	78	FLAT WASHER (Ø6xØ25x1)	1
10	ARBOR SUPPORT BRACKET	1	79	SOCKET CAP SCREW (M6x16xP1.0)	1
11	TRUSS HEAD MACHINE SCREW (M5x8xP0.8)	2	80	SWITCH GUARD BAR (90MM)	2
12	NEEDLE BEARING (HK 3516)	1	81	SWITCH PANEL (90x110x1.5T)	1
13	SPRING WASHER (M8)	3	82	MOTOR SWITCH (110V/220V)	1
14	SOCKET CAP SCREW (M8x55xP1.25)	2	83	MAGNET SWITCH (110V&220V)	1
15	SOCKET CAP SCREW (M8x30xP1.25)	1	84	GIB STRIP-LEFT (258MM)	1
16	WATER SEAL (Ø16x16)	1	85	GIB STRIP-RIGHT (258MM)	1
17	SPRING (Ø1.5xØ13.3xØ16.3x16T1x140L)	1	86	GIB TENSIONER (258x11x1.2T)	1
18	SPINDLE (M27-121MM)	1	87	PANHEAD MACHINE SCREW (M4x16xP0.7)	1
19	PARALLEL KEY (5x5x10)	1	88	EXTERNAL STAR WASHER (M5)	1
20	OIL SEAL (Ø28xØ40x7)	2	89	SPRING WASHER (M6)	3
21	PANHEAD TAPPING SCREW (M5x70)	4	90	ELECTROMAGNET (164x80x48)	1
22	GEAR HOUSING	1	91	SIDE PANEL (110x90x1.5T)	1
23	PUSH LOCK FITTING (PT1/8"xØ6)	1	92	OVER LOAD PROTECTION (110V-220V)	1
24	BALL BEARING (6003)	2	93	PANHEAD MACHINE SCREW (M4x30xP0.7)	2
25	INTERNAL CIRCLIP (R-35)	1	94	PANHEAD MACHINE SCREW (M4x8xP0.7)	4
26	EXTERNAL CIRCLIP (S-17)	1	95	RECTIFIER (110&220V)	1
27	OUTPUT GEAR (M1.25x3T)	1	95-1	RECTIFIER & EMC (110V&220V)	1
28	EXTERNAL CIRCLIP (S-15)	1	96	CRANK SPINDLE (Ø28)	1
29	BALL BEARING (608)	6	97	CRANK HANDLE	3
30	PARALLEL KEY (4x4x8)	2	98	CABLE PROTECTOR (5/16"x7CM)	1
31	COUNTERSHAFT (M1.25x12T)	1	99	CORD ARMOR	1
32	LAY GEAR (M1.0x34T)	1	100	POWER SUPPLY CABLE	1
33	EXTERNAL CIRCLIP (S10)	2	101	CABLE GLAND (5/16")	1
34	INPUT SHAFT (M1.0 x 9T)	1	103	FLAT WASHER (Ø6xØ13x1)	2
35	INPUT GEAR (M1.0x30T)	1	104	BUTTERFLY SCREW (M6x10xP1.0)	2
36	PARALLEL KEY (4x4x30)	1	105	WIRE LEAD (1015-16#18CM)	4
37	GEAR PLATE	1	106	WIRE LEAD (1015-16#18CM)	2
38	BALL BEARING (6001)	1	107	COMBINATION WRENCH (M8)	1
39	ARMATURE (110V-220V-73x42x45)	1	108	HEX KEY (M2.5)	1
40	PANHEAD TAPPING SCREW (M5x60)	2	109	HEX KEY (M4)	1
41	STATOR (110V-220V-73x42x45)	1	110	CHIP GUARD	1
42	MOTOR HOUSING	1	112	RUBBER WASHER (Ø4xØ11x1)	1
43	HEX NUT (M4xP0.7)	8	113	FEMALE SPADE TERMINAL	4
44	CARBON BRUSH HOLDER (7x11)	2	114	SPADE TERMINAL BOOT	8
45	CARBON BRUSH (7x11x17)	2	115	ZIP TIE (2.4x80MM)	1
46	BRUSH SPRING (Ø.35x3x3T)	2	116	PANHEAD MACHINE SCREW (M4x25xP0.7)	3
47	PANHEAD MACHINE SCREW (M4x10xP0.7)	2	117	LOCK PIN (12.3MM/11.7MM)	2
48	PANHEAD TAPPING SCREW (M4x12)	4	118	PANHEAD MACHINE SCREW (M3x4xP0.5)	2
49	MOTOR TAIL CASTING	1	119	LOCK PIN SPRING	2
50	PANHEAD TAPPING SCREW (M4x25)	2	120	CHUCK (1/2")	1
51	CABLE CLIP	2	121	CHUCK ADAPTOR (M27 / 1/2")	1
52	PANHEAD TAPPING SCREW (M4x14)	2	123	PILOT PIN (HSSx7LxØ6.34)	1
53	CRIMP CAP CONNECTOR (C4)	3	123	PILOT PIN (HSSx103LxØ6.34)	1
54	CABLE CLAMP	2	123	PILOT PIN (TCTx90LxØ7.98)	1
55	WIRE (1.25x2Cx6SCM-VCTF)	1	123	PILOT PIN (TCTx90LxØ6.34)	1
56	CABLE PROTECTOR (5/16"x40CM)	1	123	PILOT PIN (TCTx106LxØ6.34)	1
57	TUBE (Ø4xØ6x20CM)	1	123	PILOT PIN (TCTx108LxØ7.98)	1
62	COOLANT TANK ASSEMBLY	1	124	SOCKET SET SCREW (M8x7xP1.25)	2
63	SOCKET CAP SCREW (M6x20xP1.0)	5	125	ARBOR (M27-122.5L)	1
64	SLIDE PLATE (L238MM)	1	126	EARTHING MARKING	1
65	COOLANT TANK BRACKET	1	127	FAN SHROUD	1
66	FLAT WASHER (Ø5xØ12x1)	2	128	SAFETY BELT	1
67	THUMB SCREW (M5x16)	3	129	CHIP GUARD	1
68	GEAR RACK (M1.5x150L)	1			

NO.	Parts Name	Q'TY	NO.	Parts Name	Q'TY
1	SOCKET SET SCREW (M8x7xP1.25)	2	81	EXTERNAL STAR WASHER (M5)	1
2	ARBOR (M27-122.5L)	1	82	LIMIT SWITCH (110V&220V)	1
3	ARBOR SUPPORT BRACKET	1	83	PIN	2
4	TRUSS HEAD MACHINE SCREW (M5x8xP0.8)	2	84	GIB TENSIONER (258x11x1.2T)	1
5	SPRING WASHER (M8)	3	85	GIB STRIP-RIGHT (258MM)	1
6	SOCKET CAP SCREW (M8x5xP1.25)	2	86	GIB STRIP-LEFT (258MM)	1
7	SOCKET CAP SCREW (M8x30xP1.25)	1	87	FEED MOTOR	1
8	SOCKET CAP SCREW (M6x20xP1.0)	5	88	FEED MOTOR GEAR BOX	1
9	SPRING WASHER (M6)	3	89	BUSHING (Ø8xØ12x6)	2
10	ELECTROMAGNET (164x80x48)	1	90	FEED INTERMEDIATE GEAR (10T)	1
11	NEEDLE BEARING (HK 3516)	1	91	PARALLEL KEY (4x4x10)	1
12	WATER SEAL (Ø16x16)	1	92	FEED OUTPUT GEAR (80T)	1
13	SPRING (Ø1.5xØ13.3xØ16.3x16Tx140L)	1	93	BALL BEARING (6809)	1
14	SPINDLE (M27-121MM)	1	94	ENGAGEMENT GEAR (63T)	1
15	PARALLEL KEY (5x5x10)	1	95	EXTERNAL CIRCLIP (S-30)	1
16	OIL SEAL (Ø28xØ40x7)	2	96	FEED SUPPORT BASE	1
17	PANHEAD TAPPING SCREW (M5x70)	4	97	FLAT HEAD MACHINE SCREW (M5x15xP0.8)	4
18	PUSH LOCK FITTING (PT1/8"xØ6)	1	98	FLAT HEAD MACHINE SCREW (M5x30xP0.8)	4
19	GEAR HOUSING	1	99	AUTO FEED COVER	1
20	PARALLEL KEY (4x4x30)	1	100	PANHEAD TAPPING SCREW (M5x20)	5
21	BALL BEARING (6003)	2	101	CAPACITOR (110V/220V)	1
22	INTERNAL CIRCLIP (R-35)	1	102	ELECTRONICS BOARD (110V/220V)	1
23	EXTERNAL CIRCLIP (S-17)	1	103	SIDE PANEL (125x82x1.5T)	1
24	OUTPUT GEAR (M1.25x37T)	1	104	PANHEAD TAPPING SCREW (M3.5x6)	4
25	EXTERNAL CIRCLIP (S-15)	1	105	PANHEAD MACHINE SCREW (M4x8xP0.7)	7
26	BALL BEARING (608)	6	106	PANHEAD MACHINE SCREW (M4x30xP0.7)	2
27	PARALLEL KEY (4x4x8)	2	107	CABLE PROTECTOR (5/16"x7CM)	1
28	COUNTERSHAFT (M1.25x12T)	1	108	CORD ARMOR	1
29	LAY GEAR (M1.0x34T)	1	109	POWER SUPPLY CABLE	1
30	EXTERNAL CIRCLIP (S10)	2	110	TRUSS HEAD MACHINE SCREW (M4x10xP0.7)	1
31	INPUT SHAFT (M1.0 x 9T)	1	111	SELECTOR CAM	1
32	INPUT GEAR (M1.0x30T)	1	112	CHECK BALL (Ø5)	8
33	GEAR PLATE	1	113	CRANK SPINDLE (Ø28)	1
34	BALL BEARING (6001)	1	114	SELECTOR ROD	1
35	ARMATURE (110V/220V-73x42x45)	1	115	CRANK HUB	1
36	PANHEAD TAPPING SCREW (M5x60)	2	116	SOCKET SET SCREW (M8x10xP1.25)	3
37	STATOR (110V-220V-73x42x45)	1	117	DETENT UNIT (M6x13xP1.0)	1
38	MOTOR HOUSING	1	118	ROLL PIN (Ø4.2x25)	3
39	HEX NUT (M4xP0.7)	5	119	CRANK LEVER TIP	3
40	CARBON BRUSH HOLDER (7x11)	2	120	CRANK LEVER	3
41	CARBON BRUSH (7x1x1x17)	2	121	CRANK GRIP	3
42	BRUSH SPRING (0.35x3x3T)	2	122	HUB COVER	1
43	PANHEAD MACHINE SCREW (M4x10xP0.7)	2	123	FLAT WASHER (Ø6xØ13x1)	2
44	PANHEAD TAPPING SCREW (M4x12)	4	124	BUTTERFLY SCREW (M6x10xP1.0)	2
45	MOTOR TAIL CASTING	1	125	CHIP GUARD	1
46	PANHEAD TAPPING SCREW (M4x25)	2	127	WRENCH (M8)	1
47	CABLE PROTECTOR (5/16"x40CM)	1	128	HEX KEY (M2.5)	1
48	WIRE (1.25x2CxØ80CM-VCTF)	1	129	HEX KEY (M4)	1
49	CABLE CLAMP	1	130	PANHEAD MACHINE SCREW (M4x16xP0.7)	1
50	PANHEAD TAPPING SCREW (M4x14)	2	131	FEMALE SPADE TERMINAL	4
51	CABLE CLIP	2	132	RUBBER WASHER (Ø4xØ11x1)	1
52	CRIMP CAP CONNECTOR (C4)	3	133	SPADE TERMINAL BOOT	8
53	GEAR RACK (M1.5x150L)	1	134	ZIP TIE (2.4x80MM)	1
54	SOCKET CAP SCREW (M8x16xP1.25)	2	135	HUB PLATE	1
55	SLIDE PLATE (L238MM)	1	136	CHUCK ADAPTOR (M27 / 1/2")	1
56	SOCKET CAP SCREW (M5x16xP0.8)	2	137	CHUCK (1/2")	1
57	FLAT WASHER (Ø5xØ12x1)	2	139	PILOT PIN (HSSx77LxØ6.34)	1
58	COOLANT TANK BRACKET	1	139	PILOT PIN (HSSx103LxØ6.34)	1
59	COOLANT TANK ASSEMBLY	1	139	PILOT PIN (TCTx90LxØ7.98)	1
64	TUBE (Ø4xØ6x20CM)	1	139	PILOT PIN (TCTx90LxØ6.34)	1
65	CABLE GLAND (5/16")	1	139	PILOT PIN (TCTx106LxØ6.34)	1
66	BUSHING (Ø28xØ32x12)	2	139	PILOT PIN (TCTx108LxØ7.98)	1
67	STAND BODY	1	140	SWITCH BOOT	2
68	MAIN SWITCH-3 POSITION (110V&220V)	1	141	EARTHING MARKING	1
69	SOCKET CAP SCREW (M4x16xP0.7)	4	142	FAN SHROUD	1
70	SPRING WASHER (M4)	4	143	SAFETY BELT	1
71	FLAT WASHER (Ø4xØ10x1)	6	144	ZIP TIE (2.5x100MM)	1
72	SWITCH PANEL (125x82x1.5T)	1	145	CHIP GUARD	1
73	MAGNET SWITCH (110V&220V)	1	146	FEED MOTOR	1
76	SWITCH GUARD BAR (64MM)	2	146-1	MAIN SWITCH-3 POSITION (110V&220V)	1
77	MOTOR ON SWITCH (110V&220V)	1	146-2	FEED MOTOR	1
78	MOTOR OFF SWITCH (110V&220V)	1	146-3	FEED MOTOR GEAR BOX	1
79	HEX NUT (M5xP0.8)	6	146-4	FEED SUPPORT BASE	1
80	SOCKET SET SCREW (M5x20xP0.8)	6	146-5	FLAT HEAD MACHINE SCREW (M5x30xP0.8)	4

HF-750(D9507) 4 Speed Drilling System Exploded View & Parts list

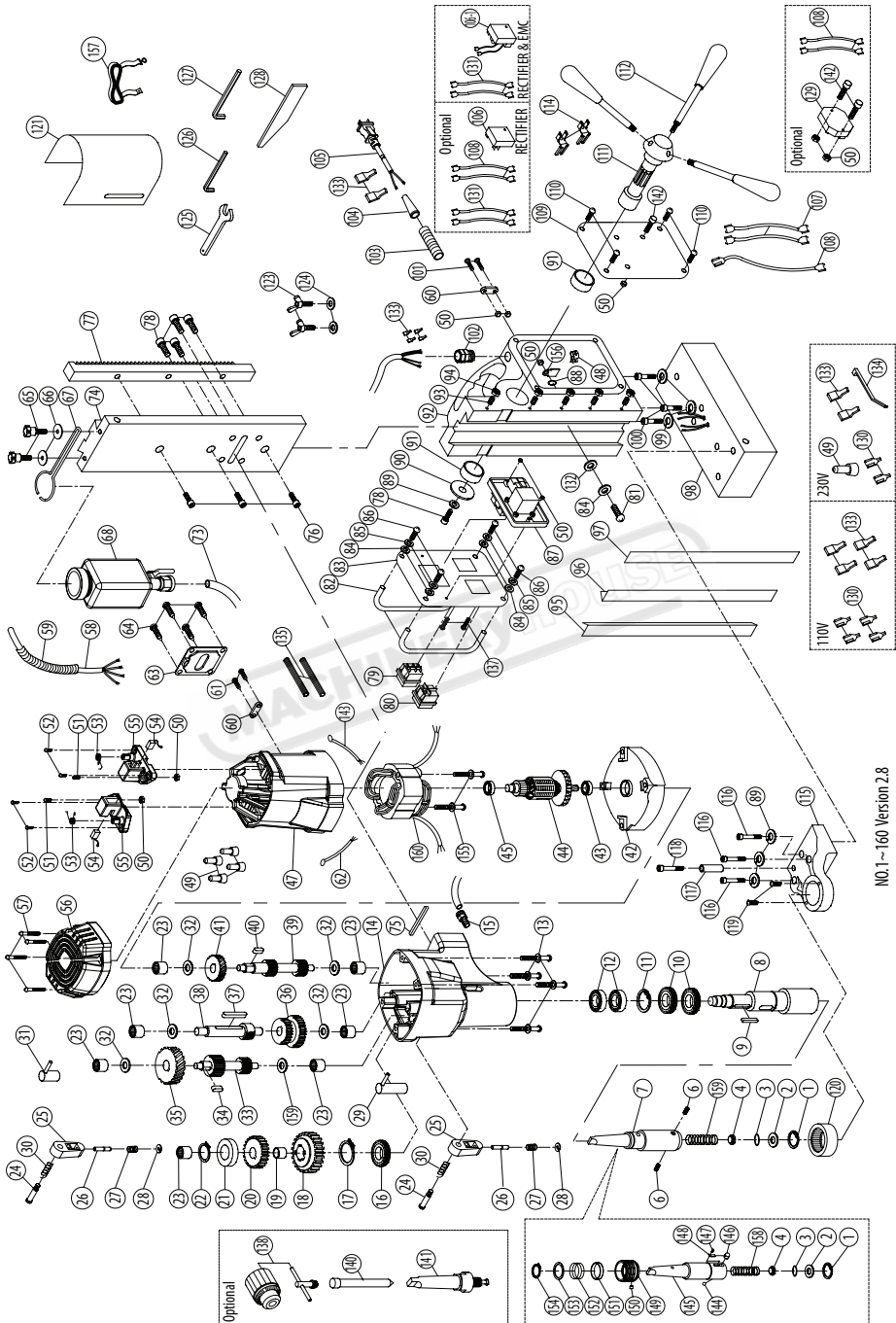

NO.1 ~ 160 Version 2.8

NO.	Parts Name	QTY	83	SWITCH PANEL (130.5x90.5x1.5T)	1
1	INTERNAL CIRCLIP (R-19)	1	84	FLAT WASHER (04x010x1)	5
2	FLAT WASHER (010x018.5x0.8)	1	85	SPRING WASHER (M4)	4
3	O-RING (012x4)	1	86	SOCKET CAP SCREW (M4x16xP0.7)	1
4	WATER SEAL (012x15)(WHITE)	1	87	MOTOR SWITCH (110V/220V)	4
5	SPRING (01.2x010x012.4x241x140L)	1	88	EXTERNAL STAR WASHER (M5)	1
6	SOCKET SET SCREW (M8x7xP1.25)	2	89	SPRING WASHER (M8)	4
7	ARBOR (MT3-019)	1	90	FLAT WASHER (08x040x2.5)	1
8	SPINDLE (MT3-199.8MM)	1	91	BUSHING (032x038x12)	2
9	PARALLEL KEY (5x5x40)	1	92	STAND BODY	1
10	OIL SEAL (040x055x7)	2	93	SOCKET SET SCREW (M5x25xP0.8)	5
11	INTERNAL CIRCLIP (R-55)	1	94	HEX NUT (M5xP0.8)	5
12	BALL BEARING (6006)	2	95	GIB STRIP-LEFT (308MM)	1
13	PANHEAD TAPPING SCREW (M5x65)	4	96	GIB STRIP-RIGHT (308MM)	1
14	GEAR HOUSING	1	97	GIB TENSIONER (308x15x1.2T)	1
15	PUSH LOCK FITTING (PT1/8"x06)	1	98	ELECTROMAGNET (200x100x68)	1
16	OIL SEAL (030x045x5)	1	99	SPRING WASHER (M6)	3
17	EXTERNAL CIRCLIP (S-30)	1	100	SOCKET CAP SCREW (M6x20xP1.0)	3
18	LOW SPINDLE GEAR (DP10/12x21T)	1	101	PANHEAD MACHINE SCREW (M4x30xP0.7)	2
19	BUSHING (018x020x11.5)	1	102	CABLE GLAND (3/8")	1
20	HIGH SPINDLE GEAR (M1.75x25T)	1	103	CABLE PROTECTOR (5/16"x7CM)	1
21	SPACER (014.2x022x5)	1	104	COR ARMOR	1
22	EXTERNAL CIRCLIP (S-14)	1	105	POWER SUPPLY CABLE	1
23	NEEDLE BEARING (HK 1010)	7	106	RECTIFIER (110&220V)	1
24	SHOULDER SCREW	2	106-1	RECTIFIER & EMC (110V)/(110V&220V)	1
25	SELECTOR TAB	2	107	WIRE LEAD (1015-16#9CM)	2
26	DETENT PIN (05x22.5)	2	108	WIRE LEAD (1015-16#18CM)	5
27	SPRING (00.6x05.3x06.5x17Lx5T)	2	109	SIDE PANEL (130.5x90.5x1.5T)	1
28	E-CLIP (E-3)	2	110	PANHEAD MACHINE SCREW (M4x8xP0.7)	4
29	FIRST SELECTOR FORK (012x26 / 04x25)	1	111	CRANK SPINDLE (032)	1
30	SPRING (01x09x011x11x4T)	2	112	CRANK HANDLE	3
31	SECOND SELECTOR FORK (012x21 / 04x32.2)	1	114	THREE WIRE PUSH IN CONNECTOR	2
32	THRUST RING (1024)	5	115	ARBOR SUPPORT BRACKET	1
33	IDLER SHAFT (M1.75x161x7T)	1	116	SOCKET CAP SCREW (M8x25xP1.25)	3
34	PARALLEL KEY (5x5x10)	1	117	TRAVEL STOP (06.5x012x34)	1
35	IDLER GEAR (M1.75x36T)	1	118	SOCKET CAP SCREW (M6x45xP1.0)	1
36	LAY GEAR (M1.25x28Tx30T)	1	119	TRUSS HEAD MACHINE SCREW (M4x6xP0.7)	2
37	PARALLEL KEY (5x5x50)	1	120	NEEDLE BEARING (HK 3516)	1
38	COUNTERSHAFT (M1.25x12T)	1	121	CHIP GUARD	1
39	INPUT SHAFT (M1.25x12Tx10T)	1	123	BUTTERFLY SCREW (M6x10xP1.0)	2
40	PARALLEL KEY (5x5x8)	1	124	FLAT WASHER (06x013x1)	2
41	INPUT GEAR (M1.0x29T)	1	125	WRENCH (M8)	1
42	GEAR PLATE	1	126	HEX KEY (M2.5)	1
43	BALL BEARING (6202)	1	127	HEX KEY (M4)	1
44	ARMATURE (110V/220V-94x54x45)	1	128	DRIFT	1
45	BALL BEARING (6200)	1	129	OVER LOAD PROTECTION (110V/220V)	1
47	MOTOR HOUSING	1	130	FEMALE SPADE TERMINAL	4
48	CABLE CLAMP	1	131	WIRE LEAD (1015-16#18CM)	2
49	CRIMP CAP CONNECTOR (C4)	5	132	RUBBER WASHER (04x011x1)	1
50	HEX NUT (M4xP0.7)	10	133	SPADE TERMINAL BOOT	10
51	PANHEAD MACHINE SCREW (M4x10xP0.7)	2	134	ZIP TIE (2.4x100MM)	1
52	PANHEAD TAPPING SCREW (M4x12)	4	135	WIRE SLEEVE (04)	2
53	BRUSH SPRING (0.4x4x3.5T)	2	137	PANHEAD MACHINE SCREW (M4x20xP0.7)	2
54	CARBON BRUSH (7x17x17)	2	138	CHUCK (5/8")	1
55	BRUSH HOLDER (7x17)	2	140	PILOT PIN (H55x77Lx06.34)/(H55x103Lx06.34)	1
56	MOTOR TAIL CASTING	1	140	PILOT PIN (TCTx90Lx07.98)/(TCTx90Lx06.34)	1
57	PANHEAD TAPPING SCREW (M4x20)	4	140	PILOT PIN (TCTx106Lx06.34)/(TCTx108Lx07.98)	1
58	WIRE (2.0x4C86CM-5JT)	1	141	CHUCK ADAPTOR (MT3-5/8")	1
59	CABLE PROTECTOR (3/8" x50CM)	1	142	PANHEAD MACHINE SCREW (M4x25xP0.7)	3
60	CABLE CLIP	2	143	WIRE LEAD (1015-16#30CM)	1
61	PANHEAD TAPPING SCREW (M4x16)	2	144	CHECK BALL (08)	1
62	WIRE LEAD (1015-16#26CM)	1	145	QUICK RELEASE ARBOR SHAFT (MT3)	1
63	MOTOR COVER PLATE	1	146	LOCK PIN (12.3MM)/(11.7MM)	1
64	FLAT HEAD TAPPING SCREW (M5x10)	4	147	PANHEAD MACHINE SCREW (M3x4xP0.5)	1
65	THUMB SCREW (M5x16)	2	148	LOCK PIN SPRING	1
66	FLAT WASHER (05x012x1)	2	149	QUICK-RELEASE COLLAR	1
67	COOLANT TANK BRACKET	1	150	COLLAR PIN (08)	1
68	COOLANT TANK ASSEMBLY	1	151	RING (040x044x9)	1
73	TUBE (04x06x30CM)	1	152	SPRING (02.3x039x043.6x31x30L)	1
74	SLIDE PLATE (L348MM)	1	153	SPRING SEAT RING (035.1x044.5x2)	1
75	PARALLEL KEY (4x4x30)	1	154	EXTERNAL CIRCLIP (S-35)	1
76	SOCKET CAP SCREW (M8x20xP1.25)	3	155	PANHEAD TAPPING SCREW (M5x60)	2
77	GEAR RACK (M2.0x270L)	1	156	EARTHING MARKING	1
78	SOCKET CAP SCREW (M8x16xP1.25)	5	157	SAFETY BELT	1
79	REVERSING SWITCH (110V&220V)	1	158	SPRING (01.2x010x012.4x15Tx100L)	1
80	MAGNET SWITCH (110V&220V)	1	159	THRUST RING (013x024x1)	1
81	PANHEAD MACHINE SCREW (M4x16xP0.7)	1	160	STATOR (110V/220V-94x54x45)	1
82	SWITCH GUARD BAR (110MM)	2			